



Information Sheet [Black Box Theatre]

Lighting:

<u>Fixture</u>	<u>Lamp</u>	<u>Quantity</u>
Selecon Acclaim 4" Fresnel	JCS120 – 575w	10
Selecon Rama 6" Fresnel	BTN – 750w	18
Selecon Acclaim Axia 24-44	HX – 601 (575w)	26
Zoomspot		

<u>Lighting Accessories</u>	<u>Quantity</u>
4 ½" color frames	36
7 ½" color frames	18
"M" size steel pattern holders	10
"M" size glass pattern holders	2

<u>Controls / Dimming</u>	<u>Quantity</u>
ETC Element Control Console (40 faders, 250 channels)	1
BAK – PAK portable dimmers - We ask that you not remove the dimmers from the fixtures	5

<u>Accessories</u>	<u>Quantity</u>
10' Edison to L5-20 Extension	1
20' L5-20 Extensions	12
L5-20 Two-fers	8
10' 5 pin DMX Cables	53
25' 5 pin DMX Cables	3
5 pin DMX Terminator	1

<u>Accessories</u>	<u>Quantity</u>
10' Edison to L5-20 Extension	1
20' L5-20 Extensions	12
L5-20 Two-fers	8
10' 5 pin DMX Cables	53
25' 5 pin DMX Cables	3
5 pin DMX Terminator	1

<u>Instruments</u>	<u>Quantity</u>
Selecon Acclaim Zoomspots	26
Selecon Acclaim 4" Fresnels	11
Selecon Rama 6" Fresnels	18

<u>Frames</u>	<u>Quantity</u>
Zoomspot/4" Fresnel Frames	37
6" Fresnel Frames	23

Gobo Frames for Zoomspots	11
---------------------------	----

<u>Barn Doors</u>	<u>Quantity</u>
For 4" Fresnels	9
For 6" Fresnels	17

<u>DMX Cables</u>	<u>Quantity</u>
10'	57
25'	4
50'	1
100'	1

<u>Power Cables</u>	<u>Quantity</u>
3'	13
4'	22
20'	4
"Long Length" extensions	7
Edison(f) to twist lock(m) converters	7
Real two-fers (short)	8
Created two-fers (longer)	6

<u>Lamps</u>	<u>Quantity</u>
EHG (use?)	7
JCS (4" Fresnels)	3
BTN (6" Fresnels)	18

<u>Miscellaneous</u>	<u>Quantity</u>
Extra dimmer backpacks	4

Audio:

<u>Item</u>	<u>Quantity</u>
Yamaha MG 24/14 Fx Mixer Board	1
DBX 2231 Equalizer	2
Crown CTs 3000 Amplifier	2
Crown CTs 600 Amplifier	1
DBX 166x1 Compressor	2
Denon DN-D4500 Dual Well CD Player w/ control	1
Custom sound rack with table	1
28' L5-20 Power Cable	3
Lav Mic with belt pack	4
Generic microphone	2
JBL AM 6212/95 Speaker	4

<u>Communications Equipment</u>	<u>Quantity</u>
DME DX200 Wireless Receiver (Digital)	1
HME Battery Charger	1
HME Battery Charger Power Supply	1
HME BP200 Transmitter (Digital)	4
HME Battery Packs	8
HME Transmitter Cases	4
HME Headsets	5

General Information:

Seating Options

- Modular seating risers. Will seat up to 100 seats depending on configuration.
- Must use own labor to arrange seats.

Other

- Must run own show. Kranzberg Arts Center provides no staff or faculty for shows unless otherwise agreed upon.
- JBL speakers are loose hung on pipe clamps. It is the responsibility of the sound crew to hang the speakers where they desire and connect all speakers into the system. Cables are provided.
- All components of this system are housed in the sound rack.
- The sound rack and tables are rolling and will need to be placed where desired as long as it is within 25' of the power source in the northeast corner of the spaces.

You will find drawings of the space attached. Should you have any further questions about the Kranzberg Arts Center Black Box Theatre or if you would like to know the availability or rental rates, please contact:

Chris Hansen
Director of Theatres & Events
Kranzberg Arts Center
chris@kranzbergartscenter.org
314-753-3539

Robert Harris
Events & Media Manager
Kranzberg Arts Center
robert@kranzbergartscenter.org
314-795-3225

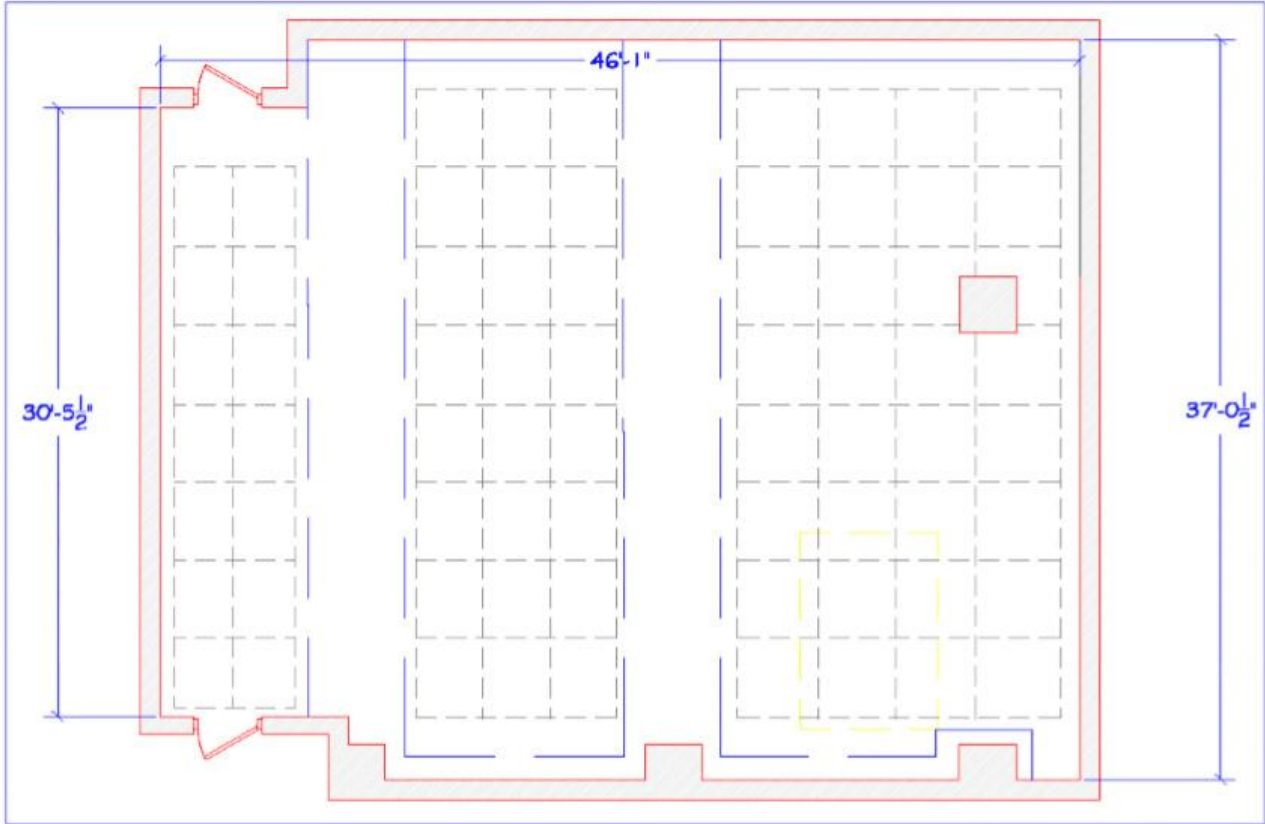

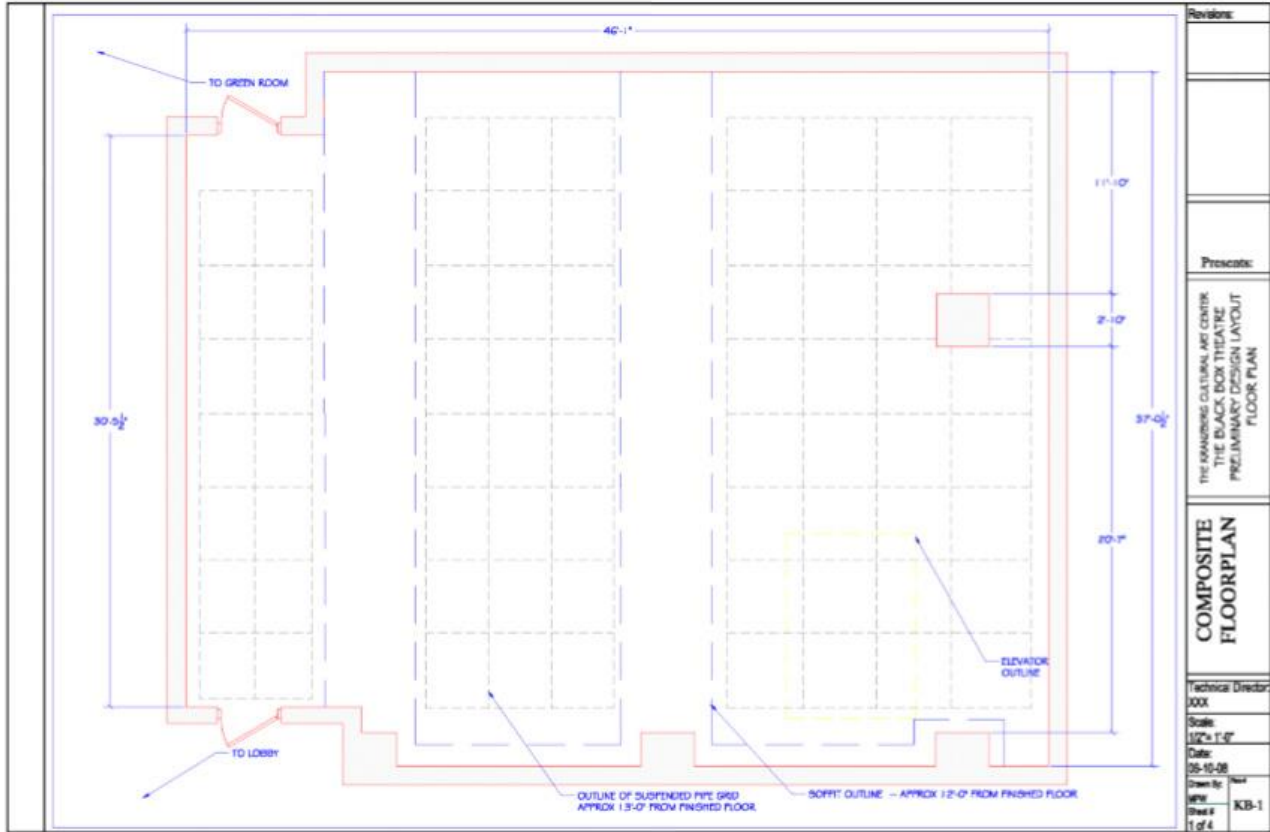

Revisions:

Proposed:

THE BOARDING CULTURAL ART CENTER
 THE BLACK BOX THEATRE
 PRELIMINARY DESIGN LAYOUT
 FLOOR PLAN

**COMPOSITE
 FLOORPLAN**

Technical Director:

XXX

Scale:

1/2" = 1'-0"

Date:

05-10-08

Drawn by:

WPH

Sheet #

1 of 4

KB-1

